

1

km 0 + 000

W = 1,46
N = 0

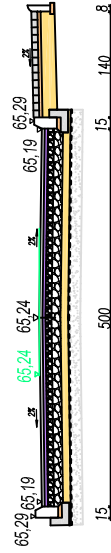

2

km 0 + 014,00

W = 1,96
N = 0

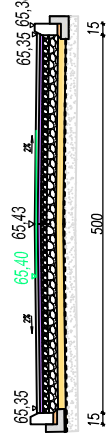

3

km 0 + 041,00

W = 1,25
N = 0,00

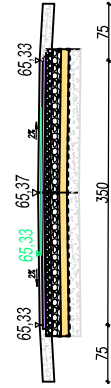

4

km 0 + 060,50

W = 1,33
N = 0,00

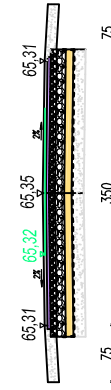

5

km 0 + 098,00

W = 1,88
N = 0,00

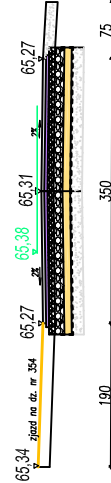

6

km 0 + 121,00

W = 1,44
N = 0,00

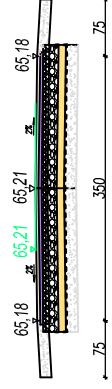

7

km 0 + 155,80

W = 1,44
N = 0,00

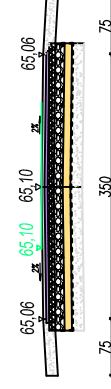

8

km 0 + 183,00

W = 1,57
N = 0,00

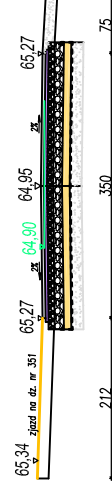

9

km 0 + 203,30

W = 1,90
N = 0,00

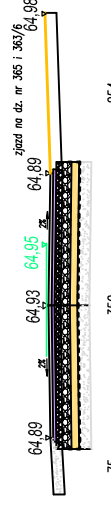

10

km 0 + 240,60

W = 1,48
N = 0

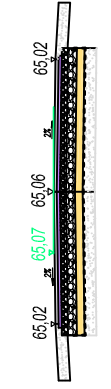

11

km 0 + 294,40

W = 1,48
N = 0

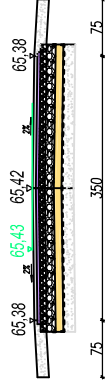

12

km 0 + 312,50

W = 1,29
N = 0,00

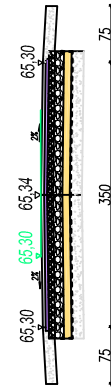

13

km 0 + 344,50

W = 1,56
N = 0,00

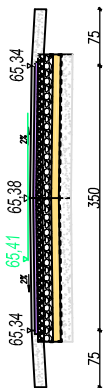

14

km 0 + 393,00

W = 1,41
N = 0,00

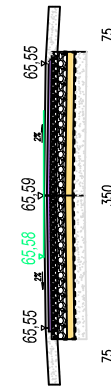

rzędna (sm. terenu)

projektowana
rzędna

Nazwa i adres obiektu budowlanego: Przebudowa drogi gminnej w miejscowości Nowy Dulinów - ulica Wierzbowa o długości 693,50mb.		Skala: 1:100		Numer rysunku: 5	
Nazwa i adres:		Specjalność i numer licencji:		Data:	
Imię i nazwisko projektanta:		Data:		02.2012	
		Podpis:			